

QUICK REFERENCE GUIDE

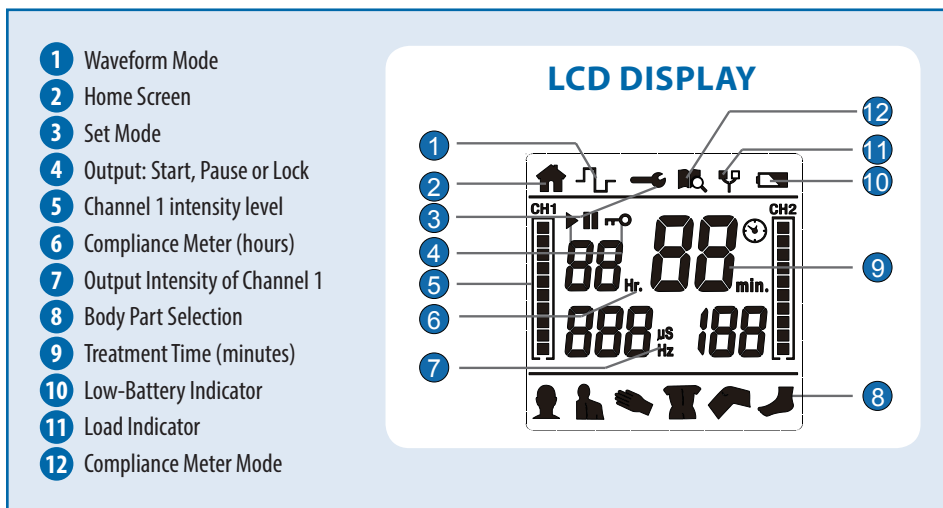

The purpose of this guide is to assist you in correctly operating your InTENSity™ 12 TENS (DI1212) unit. This device should only be used under the continued supervision of a licensed physician. This guide is not intended to replace or substitute the InTENSity™ 12 Instruction Manual. **PLEASE READ THE INSTRUCTION MANUAL COMPLETELY BEFORE USING THIS DEVICE.** Read, understand and practice the IMPORTANT SAFETY PRECAUTIONS AND WARNINGS found on pages 6 – 12 of your user manual. Always follow the operating instructions prescribed by your healthcare provider.

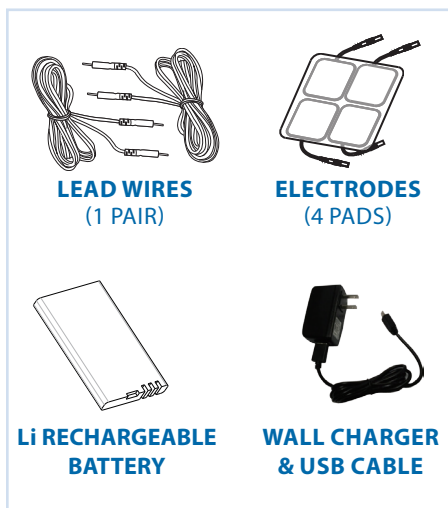
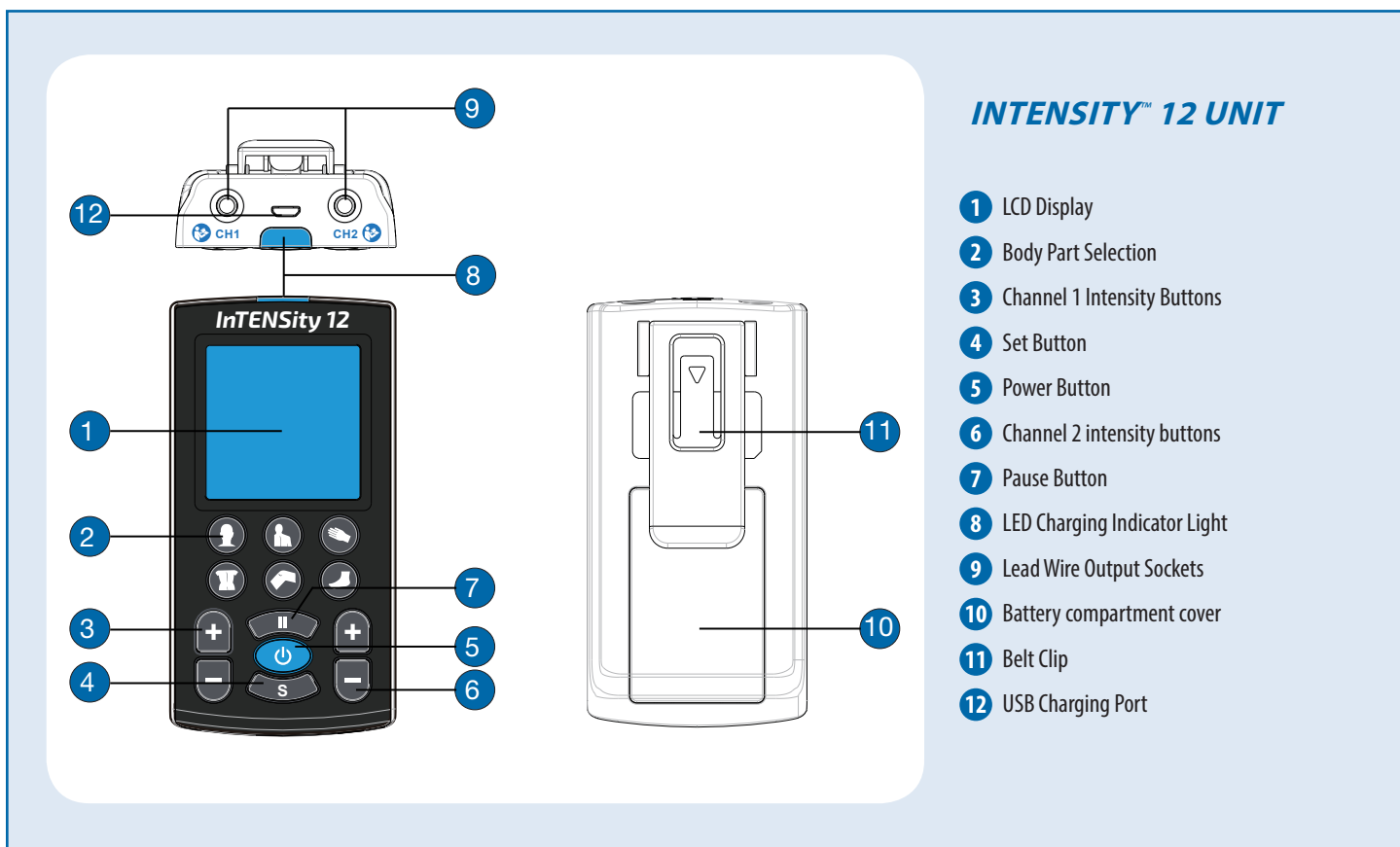

QUICK REFERENCE GUIDE



IMPORTANT!

Never remove the self-adhesive electrodes from the skin while the device is turned on!

WARNING: Device will not work while charging. Device is partially charged upon receipt.

If the electrodes are not placed firmly on the skin or the device has not connected with the lead wires securely, and the output intensity level is equal or greater than 10mA, the intensity will stop automatically.

1 INSERT BATTERY

Press down on the belt clip to release it. Remove the battery cover and insert the battery as shown in the diagram. Replace the battery cover and belt clip.

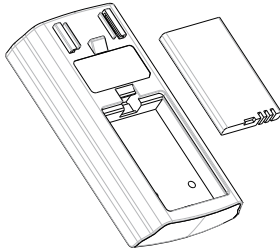

2 CONNECT LEAD WIRES

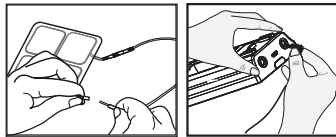

Make sure the device is completely turned OFF. Take the pads out of the sealed package; insert the lead wire pin into the electrode pigtail. Make sure no bare metal is exposed.

Insert the lead wires into the output sockets located at the top of the device. Note: If only using one channel, only plug in 1 lead wire.

3 TURNING THE DEVICE ON OR OFF



Press the [**⏻**] button to turn the device "ON" or "OFF".

If there is an immediate need to pause treatment, press the [**⏸**] button to pause treatment.

Press it again to continue treatment or press [**⏻**] to stop treatment and go back to the home screen.

4 SELECT THERAPEUTIC BODY PART

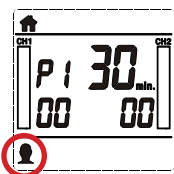

There are 6 therapeutic body part buttons available: neck, shoulder, hand, low back, knee and foot. Each therapeutic part has 3 programs – P1, P2 and U1. Total of 18 programs.

Select a body part on the device and press it. The body part will display on the LCD screen. Press the same button again to select one of the 3 programs (such as P1, P2 or U1).

5 SETTING THE MANUAL PROGRAM – U1

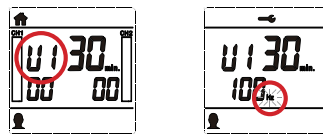

Select the body part which you want to treat. Then press the body part button until the LCD displays program "U1" like the first screen above.

Set Pulse Rate

Press [**S**] button to enter the pulse rate and the "Hz" will flash. Press [+] or [-] button to adjust pulse rate.

6 SET PULSE WIDTH

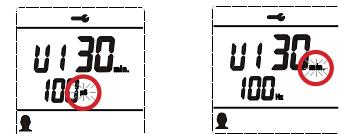

Press [**S**] button to enter the pulse width and the "μs" will flash. Press [+] or [-] button to adjust the pulse width.

Set Treatment Time

Press [**S**] button to enter treatment time and the "min." will flash. Press [+] or [-] button to adjust the treatment time.

7 SET PRESET PROGRAMS P1 & P2

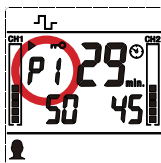

Select the body part which you want to treat. Press the body part button until the LCD displays program "P1" or "P2" like the above screen.

8 SET TREATMENT TIME

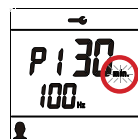

Set Treatment Time

Press [**S**] button to enter treatment time, "Min" will flash. Press [+] or [-] adjust time. When done, press [**S**] or [**⏻**] to confirm and return to the home screen.

9 START TREATMENT



Press [**CH1+**] or [**CH2+**] to increase the output intensity.

Press [**CH1-**] or [**CH2-**] to decrease the output intensity.